

PYROPULSE (PP) HYDRANT VALVE, PRESSURE REGULATING



PRODUCT DESCRIPTION

The Aventech Pyropulse Hydrant Valve (PPHV) is engineered with a simple yet reliable design, tailored for fire applications where pressure regulation is essential. This pressure regulating hydrant valve ensures optimal performance and safety during fire emergencies.

Key features include:

- **Self-Draining Design:** The PPHV features a self-draining mechanism, preventing freeze issues even in environments with ambient temperatures below 0 degrees Celsius.
- **Versatile Inlet Sizes and Pressures:** Available in various inlet sizes and pressure ratings, the PPHV can be customized to meet specific customer requirements.
- **Foam Mixing Capability:** Optional connection for constant foam orifice mixing is available, enhancing firefighting efficiency.
- **Override Functionality:** For specialized applications, the PPHV can be ordered with an override function, allowing operation without pressure regulation.
- **Material Options:** The PPHV is available in a range of high-quality materials to suit diverse operational needs and environments, including Titanium, Super Duplex, Stainless Steel, SS316, Bronze, and Nickel Aluminum Bronze (NiAlBr).
- **Adjustable Pressure Settings:** The valve features an adjustment screw, allowing for easy changes to set pressures, providing flexibility and adaptability in various fire suppression scenarios.

About Aventech

Aventech AS specializes in the design, manufacturing, and production of firefighting equipment. Supported by a robust technical background in firefighting products and systems, Aventech can assist in assessing your fire and safety needs to meet both governmental and customer requirements. Need help planning or executing? Let us guide you.

Services;

Technical Support
Installation and Setup
Maintenance
Spare Parts

MARKETS

Oil & Gas, Petrochemical, Offshore wind, Nuclear,
Waste recycling & Fire and rescue services

SECTIONAL DRAWING

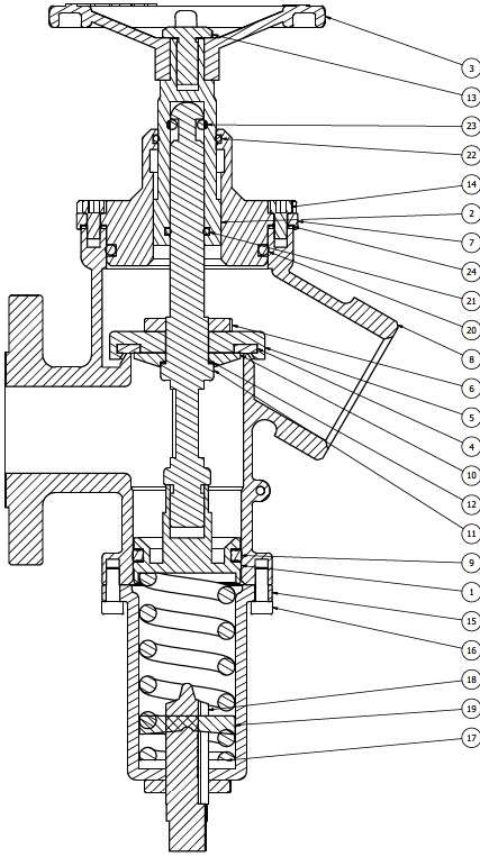

PARTS LIST				
ITEM	QTY	PART NUMBER	DESCRIPTION	MATERIAL
1	1	PPHY-IP-0003-TIT-001	Piston	Titanium
2	1	PPHY-IP-0001-TIT-001	Top Stem Holder	Titanium
3	1	PPHY-EP-0002-TIT-001	Hand Wheel	SS316
4	1	PPHY-IP-0007-NBR-001	Inner Gasket	NBR
5	1	PPHY-IP-0005-TIT-001	Gasket Lid	Titanium
6	2	PPHY-IP-0004-TIT-001	Locking Nut	Titanium
7	1	PPHY-EP-0001-TIT-001	Top Lid	Titanium
8	1	PPHY-MB-0001-TIT-001	1,5" ANSI RF - 2,5" BSPM Body	Titanium
9	1	PPHY-IP-0009-NBR-001	X-Ring	NBR
10	1	PPHY-IP-0006-TIT-001	Gasket Support	Titanium
11	1	PPHY-IP-0002-TIT-001	Inner Stem	Titanium
12	1	PPHY-IP-0011-NBR-001	Gasket Lower Stem	NBR
13	1	PPHY-EP-0004-SS316-001	Wheel Screw	SS316
14	8	PPHY-EP-0005-SS316-001	M6x12 Screw	SS316
15	1	PPHY-EP-0006-TIT-001	Spring Cup	SS316
16	4	PPHY-EP-0007-SS316-001	M6 x 16	SS316
17	1	PPHY-IP-0012-XXX-001	Spring Inconell	SS316
18	1	PPHY-IP-0013-XXX-001	Spring Adjustment Screw	SS316
19	1	PPHY-IP-0014-XXX-001	Spring Holder	SS316
20	1	PPHY-IP-0016-XXX-001	O-Ring 67x5	NBR
21	1	PPHY-IP-0017-NBR-001	O-Ring 15x3	NBR
22	1	PPHY-IP-0018-NBR-001	O-Ring 26x3	NBR
23	1	PPHY-EP-0008-SS316-001	Override Key	SS316
24	1	PPHY-IP-0010-GPH-001	Graphite Gasket SS316 Reinforced	Graphite Gasket SS316 Reinforced

Note: Sectional Drawing materials are for Titanium version.
For different materials please ask Aventech for information.

TABLE A: ALTERNATIVES

Inlet Sizes	Pressure Rating	Inlet Pressure	Outlet Sizes	Outlet Threads	Outlet Pressures
DN40 / 1,5"	150# or 300#	5-20(28) barg	DN50 / 2"	Threaded BSPM	5 - 9 barg
DN50 / 2"	150# or 300#	5-20(28) barg	DN50 / 2"	Threaded NPTM	5 - 9 barg
DN65 / 2,5"	150# or 300#	5-20(28) barg	DN65 / 2,5"	Threaded BSPM	5 - 9 barg
DN80 / 3"	150# or 300#	5-20(28) barg	DN65 / 2,5"	Threaded NPTM	5 - 9 barg

ALTERNATIVES

- High Grade materials - ranging from Titanium, Duplex, NiAlBr, SS316 & Bronze
- Override function (OPTION)
- Foam inlet arrangement (OPTION)

Upon enquiry please specify material selection, inlet & outlet sizes, pressure class and quantities.
Also we can custom-make Hydrants if there are any special needs that is not covered by this datasheet.

KEY ADVANTAGES

- DNV Type Approval is on-going.
- The equipment includes an adjustment screw on the hydrant valve for setting the pressure, with an indicator table (provided with each delivery) for easy adjustment and verification. This new solution offers simpler, more flexible pressure adjustments compared to traditional valves.
- Aventech can also deliver relevant accessories such as hoses, nozzles, stand pipes and other relevant equipment to your projects.



Adjustment screw.